

Accessories

Fittings & Tubings

CATALOG



ASCO[®]
NUMATICS[®]

How to Order

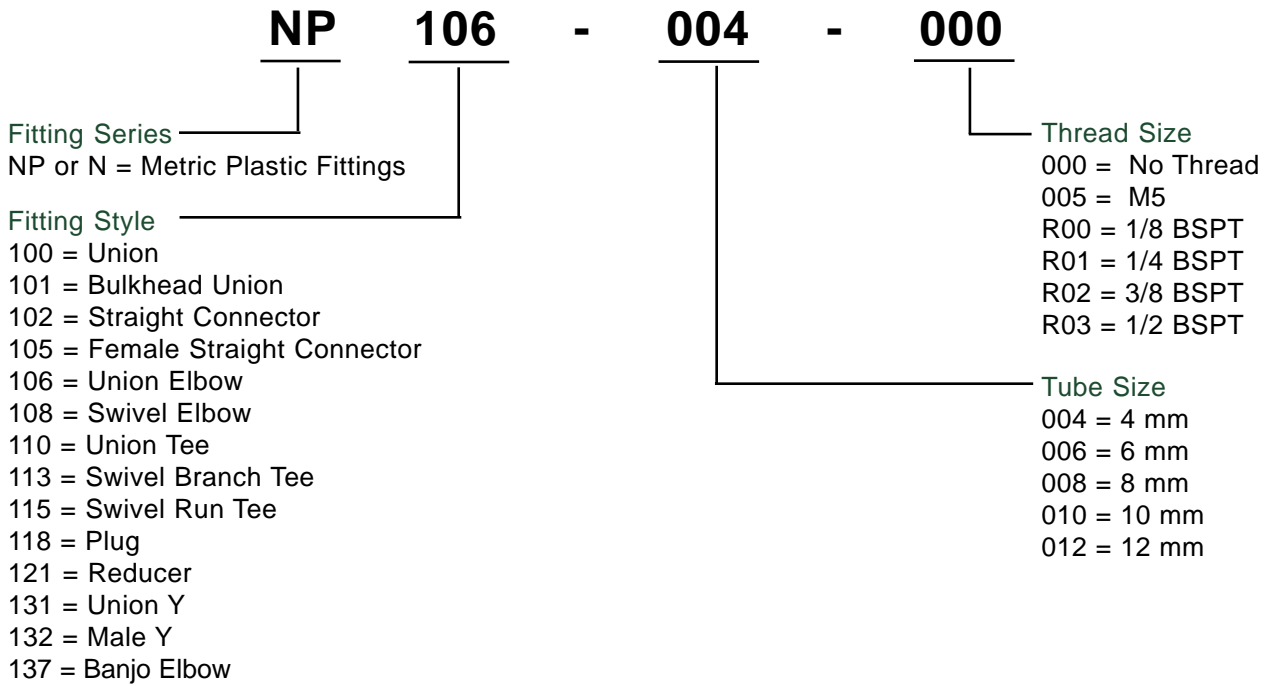

- Pressure rating to 15 bar
- Vacuum rating to 29 inches of Mercury
- Temperature range: -20°C to +60°C
- Push-in fittings with BSPT threads
- Teflon thread sealant
- Tube diameter: 4 mm to 12 mm
- Thread size: M5 to 1/2 BSPT

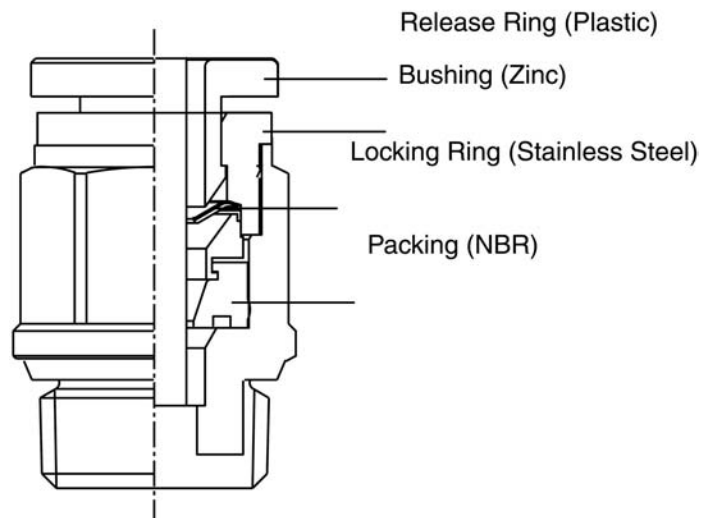

Composite Metric Fittings with BSPT Thread

NP100 Union

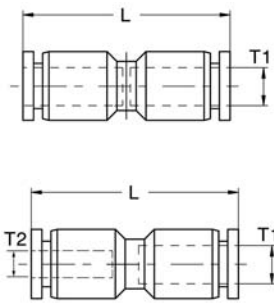

NP100	Tube Diameter (T1)	Tube Diameter (T2)	L
NP100-004-000	4.0	-	33.0
NP100-006-000	6.0	-	35.2
NP100-006-004	6.0	4.0	34.9
NP100-008-000	8.0	-	39.1
NP100-008-006	8.0	6.0	38.6
NP100-010-000	10.0	-	47.8
NP100-010-008	10.0	8.0	47.3
NP100-012-000	12.0	-	49.2

N101 Bulkhead Union

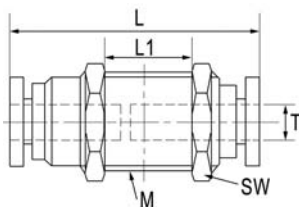

N101	Tube Diameter (T)	M	L	L1	SW
N101-004-000	4.0	M12	30.1	9.7	14
N101-006-000	6.0	M14	31.8	7.5	17
N101-008-000	8.0	M16	35.3	6.8	19
N101-010-000	10.0	M20	41.6	11.5	24
N101-012-000	12.0	M22	45.3	12.8	27

N102 Straight Connector

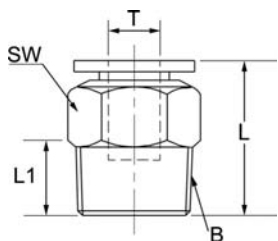

N102	Tube Diameter (T)	Thread (B)	L	L1	SW
N102-004-005	4.0	M5	19.3	4.0	10
N102-004-R00	4.0	1/8	19.8	7.5	10
N102-004-R01	4.0	1/4	17.9	9.5	14
N102-004-R02	4.0	3/8	19.6	10.5	17
N102-006-005	6.0	M5	20.7	4.0	12
N102-006-R00	6.0	1/8	21.0	7.5	12
N102-006-R01	6.0	1/4	22.7	9.5	14
N102-006-R02	6.0	3/8	20.7	10.5	17
N102-006-R03	6.0	1/2	24.7	13.5	21
N102-008-R00	8.0	1/8	25.9	7.5	14
N102-008-R01	8.0	1/4	24.9	9.5	14
N102-008-R02	8.0	3/8	21.9	10.5	17
N102-008-R03	8.0	1/2	25.9	13.5	21
N102-010-R00	10.0	1/8	29.5	7.5	17
N102-010-R01	10.0	1/4	30.8	9.5	17
N102-010-R02	10.0	3/8	28.3	10.5	17
N102-010-R03	10.0	1/2	26.6	13.5	21
N102-012-R00	12.0	1/8	31.6	7.5	21
N102-012-R01	12.0	1/4	33.6	9.5	21
N102-012-R02	12.0	3/8	30.6	10.5	21
N102-012-R03	12.0	1/2	33.6	13.5	21

N105 Female Straight Connector

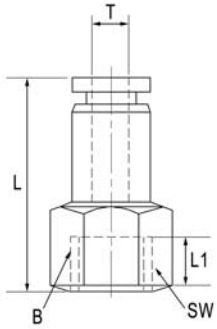

N105	Tube Diameter (T)	Thread (B)	L	L1	SW
N105-004-R00	4.0	1/8	23.3	8	14
N105-004-R01	4.0	1/4	26.3	11	17
N105-006-R00	6.0	1/8	24.4	8	14
N105-006-R01	6.0	1/4	27.4	11	17
N105-006-R02	6.0	3/8	28.4	12	21
N105-006-R03	6.0	1/2	30.4	14	24
N105-008-R00	8.0	1/8	25.9	8	14
N105-008-R01	8.0	1/4	28.9	11	17
N105-008-R02	8.0	3/8	29.9	12	21
N105-008-R03	8.0	1/2	31.9	14	24
N105-010-R00	10.0	1/8	29.0	8	17
N105-010-R01	10.0	1/4	32.0	11	17
N105-010-R02	10.0	3/8	33.0	12	21
N105-010-R03	10.0	1/2	35.0	14	24
N105-012-R01	12.0	1/4	33.9	11	21
N105-012-R02	12.0	3/8	34.9	12	21
N105-012-R03	12.0	1/2	36.9	14	24

NP106 Union Elbow

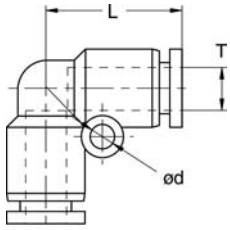

NP106	Tube Diameter (T)	L	d
NP106-004-000	4.0	17.5	-
NP106-006-000	6.0	19.0	3.2
NP106-008-000	8.0	22.8	3.2
NP106-010-000	10.0	27.6	4.2
NP106-012-000	12.0	29.6	4.3

NP108 Swivel Elbow

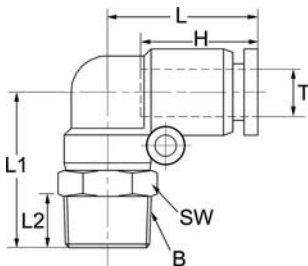

NP108	Tube Diameter (T)	Thread (B)	H	L	L1	L2	SW
NP108-004-005	4.0	M5	15.1	17.5	17.0	4.0	10
NP108-004-R00	4.0	1/8	15.1	17.5	24.0	7.5	10
NP108-004-R01	4.0	1/4	15.1	17.5	27.0	9.5	14
NP108-006-005	6.0	M5	16.0	19.0	17.5	4.0	12
NP108-006-R00	6.0	1/8	16.0	19.0	25.7	7.5	12
NP108-006-R01	6.0	1/4	16.0	19.0	28.2	9.5	14
NP108-006-R02	6.0	3/8	16.0	19.0	29.7	10.5	17
NP108-008-R00	8.0	1/8	18.1	22.8	29.5	7.5	14
NP108-008-R01	8.0	1/4	18.1	22.8	31.5	9.5	14
NP108-008-R02	8.0	3/8	18.1	22.8	33.0	10.5	17
NP108-010-R00	10.0	1/8	20.4	27.6	34.3	7.5	17
NP108-010-R01	10.0	1/4	20.4	27.6	36.3	9.5	17
NP108-010-R02	10.0	3/8	20.4	27.6	37.3	10.5	17
NP108-010-R03	10.0	1/2	20.4	27.6	40.8	13.5	21
NP108-012-R01	12.0	1/4	23.2	29.6	38.5	9.5	21
NP108-012-R02	12.0	3/8	23.2	29.6	39.5	10.5	21
NP108-012-R03	12.0	1/2	23.2	29.6	42.5	13.5	21

Composite Metric Fittings with BSPT Thread

NP110 Union Tee

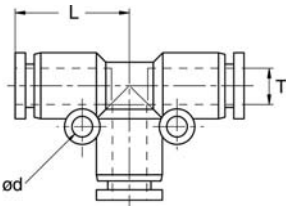

NP110	Tube Diameter (T)	L	d
NP110-004-000	4.0	18.5	3.2
NP110-006-000	6.0	19.3	3.2
NP110-008-000	8.0	22.8	3.2
NP110-010-000	10.0	28.3	4.2
NP110-012-000	12.0	29.6	4.3

NP113 Swivel Branch Tee

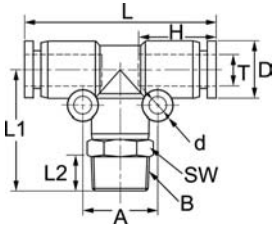

NP113	Tube Diameter (T)	Thread (B)	D	A	H	L	L1	L2	d	SW
NP113-004-005	4.0	M5	11.0	14.0	15.1	37.4	22.5	4.0	3.2	10
NP113-004-R00	4.0	1/8	11.0	14.0	15.1	37.4	25.0	7.5	3.2	10
NP113-006-005	6.0	M5	13.0	16.0	16.0	39.2	23.5	4.0	3.2	12
NP113-006-R00	6.0	1/8	13.0	16.0	16.0	39.2	26.0	7.5	3.2	12
NP113-006-R01	6.0	1/4	13.0	16.0	16.0	39.2	28.5	9.5	3.2	14
NP113-008-R00	8.0	1/8	14.8	18.0	18.1	45.5	29.5	7.5	3.2	14
NP113-008-R01	8.0	1/4	14.8	18.0	18.1	45.5	31.5	9.5	3.2	14
NP113-008-R02	8.0	3/8	14.8	18.0	18.1	45.5	33.0	10.5	3.2	17
NP113-010-R01	10.0	1/4	18.4	24.0	20.4	56.3	37.0	9.5	4.2	17
NP113-010-R02	10.0	3/8	18.4	24.0	20.4	56.3	38.0	10.5	4.2	17
NP113-010-R03	10.0	1/2	18.4	24.0	20.4	56.3	41.5	13.5	4.2	21
NP113-012-R01	12.0	1/4	21.0	27.0	23.2	59.2	38.5	9.5	4.2	21
NP113-012-R02	12.0	3/8	21.0	27.0	23.2	59.2	39.5	10.5	4.2	21
NP113-012-R03	12.0	1/2	21.0	27.0	23.2	59.2	42.5	13.5	4.2	21

NP115 Swivel Run Tee

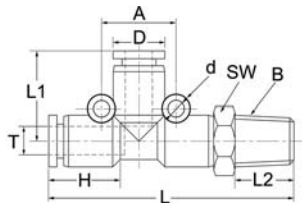

NP115	Tube Diameter (T)	Thread (B)	D	A	H	L	L1	L2	d	SW
NP115-004-005	4.0	M5	11.0	14.0	15.1	37.4	22.5	4.0	3.2	10
NP115-004-R00	4.0	1/8	11.0	14.0	15.1	44.2	18.7	7.5	3.2	10
NP115-006-005	6.0	M5	13.0	16.0	16.0	39.2	23.5	4.0	3.2	12
NP115-006-R00	6.0	1/8	13.0	16.0	16.0	45.6	19.6	7.5	3.2	12
NP115-006-R01	6.0	1/4	13.0	16.0	16.0	48.1	19.6	9.5	3.2	14
NP115-008-R00	8.0	1/8	14.8	18.0	18.1	51.7	22.8	7.5	3.2	14
NP115-008-R01	8.0	1/4	14.8	18.0	18.1	54.2	22.8	9.5	3.2	14
NP115-008-R02	8.0	3/8	14.8	18.0	18.1	55.7	22.8	10.5	3.2	17
NP115-010-R01	10.0	1/4	18.4	24.0	20.4	64.8	28.3	9.5	4.2	17
NP115-010-R02	10.0	3/8	18.4	24.0	20.4	66.3	28.3	10.5	4.2	17
NP115-010-R03	10.0	1/2	18.4	24.0	20.4	70.3	28.3	13.5	4.2	21
NP115-012-R01	12.0	1/4	21.0	27.0	23.2	67.6	29.6	9.5	4.2	21
NP115-012-R02	12.0	3/8	21.0	27.0	23.2	68.6	29.6	10.5	4.2	21
NP115-012-R03	12.0	1/2	21.0	27.0	23.2	72.6	29.6	13.5	4.2	21

NP118 Plug

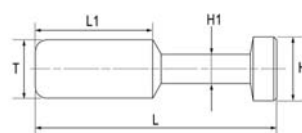

NP118	Tube Diameter (T)	L	L1	H	H1
NP118-004-000	4.0	28	15.0	5	3
NP118-006-000	6.0	33	17.0	7	3
NP118-008-000	8.0	37	18.0	9	4
NP118-010-000	10.0	42	20.5	11	5
NP118-012-000	12.0	44	23.0	13	6

NP121 Reducer

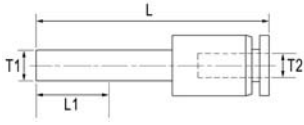

NP121	Tube Diameter (T1)	Tube Diameter (T2)	L	L1
NP121-006-004	6.0	4.0	42.0	17.0
NP121-008-004	8.0	4.0	44.5	18.0
NP121-008-006	8.0	6.0	45.0	18.0
NP121-010-006	10.0	6.0	47.0	20.0
NP121-010-008	10.0	8.0	47.0	20.0
NP121-012-008	12.0	8.0	54.0	23.5
NP121-012-010	12.0	10.0	54.5	23.5

NP131 Union Y

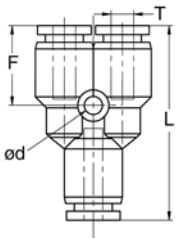

NP131	Tube Diameter (T)	L	F	d
NP131-004-000	4.0	35.5	14.0	3.2
NP131-006-000	6.0	37.1	14.8	3.2
NP131-008-000	8.0	40.4	18.2	3.2
NP131-010-000	10.0	49.7	20.8	4.2
NP131-012-000	12.0	53.2	21.6	4.2

NP132 Male Y

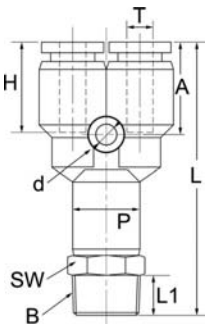

NP132	Tube Diameter (T)	Thread (B)	L	L1	A	H	P	d	SW
NP132-004-R00	4.0	1/8	42.0	7.5	14.0	15.1	11.0	3.2	10
NP132-004-R01	4.0	1/4	45.0	9.5	14.0	15.1	11.0	3.2	14
NP132-006-R00	6.0	1/8	43.8	7.5	14.8	16.0	13.0	3.2	12
NP132-006-R01	6.0	1/4	46.3	9.5	14.8	16.0	13.0	3.2	14
NP132-008-R00	8.0	1/8	47.1	7.5	18.2	18.1	14.8	3.2	14
NP132-008-R01	8.0	1/4	49.1	9.5	18.2	18.1	14.8	3.2	14
NP132-010-R01	10.0	1/4	58.4	9.5	20.8	20.4	18.4	4.2	17
NP132-010-R02	10.0	3/8	59.4	10.5	20.8	20.4	18.4	4.2	17
NP132-012-R02	12.0	3/8	61.7	10.5	21.0	23.2	21.0	4.2	21
NP132-012-R03	12.0	1/2	65.7	13.5	21.0	23.2	21.0	4.2	24

NP137 Banjo Elbow

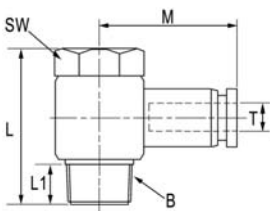

NP137	Tube Diameter (T)	Thread (B)	L	L1	M	SW
NP137-004-R00	4.0	1/8	23.5	7.5	22.3	10
NP137-006-R00	6.0	1/8	23.5	7.5	23.1	10
NP137-006-R01	6.0	1/4	26.3	9.5	25.1	14
NP137-008-R00	8.0	1/8	23.5	7.5	25.6	10
NP137-008-R01	8.0	1/4	26.3	9.5	28.6	14
NP137-008-R02	8.0	3/8	31.9	10.5	29.6	19
NP137-010-R01	10.0	1/4	26.3	9.5	32.3	14
NP137-010-R02	10.0	3/8	31.9	10.5	32.9	14
NP137-012-R02	12.0	3/8	31.9	10.5	35.6	14
NP137-012-R03	12.0	1/2	38.6	13.5	36.6	19

Flow Controls & PU Tubings

NP136C Flow Control with Knob

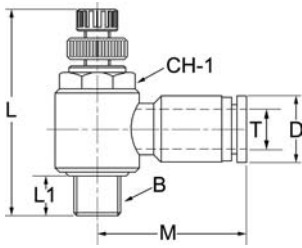

NP136C	Tube Diameter (T)	Thread (B)	D	L	M	L1	CH-1
NP136C-004-005	4.0	M5	10.0	28.2	20.0	3.8	8
NP136C-004-R00	4.0	1/8	10.0	38.9	22.3	7.5	10
NP136C-006-005	6.0	M5	12.0	28.2	21.9	3.8	8
NP136C-006-R00	6.0	1/8	12.0	38.9	23.1	7.5	10
NP136C-006-R01	6.0	1/4	12.0	46.8	25.1	11.2	14
NP136C-008-R00	8.0	1/8	14.0	38.9	25.6	7.5	10
NP136C-008-R01	8.0	1/4	14.0	46.8	28.6	11.2	14
NP136C-010-R01	10.0	1/4	17.0	46.8	32.3	11.2	14
NP136C-010-R02	10.0	3/8	17.0	52.3	32.9	12.3	19
NP136C-012-R02	12.0	3/8	20.0	52.3	35.6	12.3	19
NP136C-012-R03	12.0	1/2	20.0	56.8	36.6	14.0	24

NP136V Flow Control with Knob Meter-In

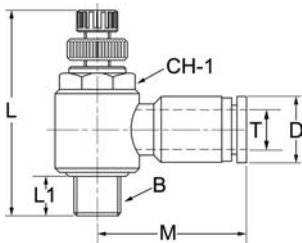

NP136V	Tube Diameter (T)	Thread (B)	D	L	M	L1	CH-1
NP136V-004-005	4.0	M5	10.0	28.2	20.0	3.8	8
NP136V-004-R00	4.0	1/8	10.0	38.9	22.3	7.5	10
NP136V-006-005	6.0	M5	12.0	28.2	21.9	3.8	8
NP136V-006-R00	6.0	1/8	12.0	38.9	23.1	7.5	10
NP136V-006-R01	6.0	1/4	12.0	46.8	25.1	11.2	14
NP136V-008-R00	8.0	1/8	14.0	38.9	25.6	7.5	10
NP136V-008-R01	8.0	1/4	14.0	46.8	28.6	11.2	14
NP136V-010-R01	10.0	1/4	17.0	46.8	32.3	11.2	14
NP136V-010-R02	10.0	3/8	17.0	52.3	32.9	12.3	19
NP136V-012-R02	12.0	3/8	20.0	52.3	35.6	12.3	19
NP136V-012-R03	12.0	1/2	20.0	56.8	36.6	14.0	24

NP139C Composite Inline Flow Control with Knob

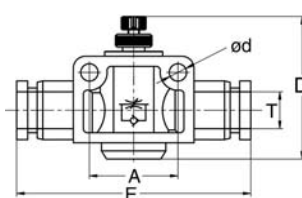

NP139C	Tube Diameter (T)	D	A	E	d
NP139C-004-000	4.0	25.7	14.0	39.5	3.2
NP139C-006-000	6.0	41.9	20.0	47.6	4.3
NP139C-008-000	8.0	45.6	22.0	52.6	4.3
NP139C-010-000	10.0	52.3	26.0	63.1	4.3
NP139C-012-000	12.0	55.0	32.0	74.2	4.3

PU (Polyurethane) Tubing

QRMU 04 BU 100 M

Tubing Series
QRMU = PU Tubing

Tube Diameter
04 = 4 mm
06 = 6 mm
08 = 8 mm
10 = 10 mm
12 = 12 mm

Unit
M = Meter
Length
50 = 50 m
100 = 100 m
200 = 200 m
Tube Colour
BU = Blue

QRMU	Tube Diameter (T)	Colour
QRMU04BU	4.0	Blue
QRMU06BU	6.0	Blue
QRMU08BU	8.0	Blue
QRMU10BU	10.0	Blue
QRMU12BU	12.0	Blue

* Minimum length for order is 50 meters.
* Minimum cut length depends on total length order.
* Ordering Example:
QRMU04BU50M x 2 = total length is 100 meters of 4mm tube, cut into 50 meters.



ASEAN Numatics Contact Information

SINGAPORE

Blk 4008, Ang Mo Kio Ave 10, #04-17/22,
TECHplace I, Singapore 569625

Tel: (65) 6556 1100

Fax: (65) 6556 0011

Email: valvesales@asconumatics.net

THAILAND

99/72, Prachachuen Road, Ladyao,
Jattujak 10900, Bangkok, Thailand

Tel: (66-2) 953 9925/6

Fax: (66-2) 953 8338

Email: thaisales@asconumatics.net

MALAYSIA

Level M2, Block A, Menara PKNS-PJ,
Jalan Yong Shook Lin, 46050, Petaling Jaya,
Selangor, Darul Ehsan, Malaysia

Tel: (60-3) 7949 9228

Fax: (60-3) 7949 9229

Email: valvesales@asconumatics.net

PHILIPPINES

Unit 902 TYCOON Centre, Pearl Drive,
Ortigas Centre, Pasig City 1600, Philippines

Tel: (63-2) 706 1165

Fax: (63-2) 706 0250

Email: valvesales@asconumatics.net

INDONESIA

Wisma 46 - Kota BNI, 16th Floor, Suite 16-01,
Jl. Jend. Sudirman Kav. 1, Jakarta 10220,
Indonesia

Tel: (62-21) 251 5027

Fax: (62-21) 251 0622

Email: valvesales@asconumatics.net



<http://www.asconumatics.net>

Local Distributor: