



D4408p

### Ex d Enclosures Flameproof Encapsulation in Moulded Plastic Series 8218

- Explosion protection to
  - CENELEC
  - IEC
- Can be used in Zone 1 and Zone 2
- Moulded plastic flameproof enclosures (Polyester resin)
- 3 different enclosure lengths
- Front plate versions:
  - Square, in moulded plastic: totally enclosed, with spindle, inspection window
  - Round, in moulded plastic: totally enclosed, with spindle, inspection window
  - Round, in metal: with spindle, bearing-supported shafts

STAHL

Switching, control, regulation, measuring and display devices can be built into series 8218 flameproof enclosures.







The enclosures are available with different front plate versions for all standard applications. These can be, for instance, inspection windows for indicating instruments, spindles for potentiometers or keypads, bearing-supported shafts for incremental shaft encoders or motors.

The incoming and outgoing leads are connected very easily via the clearly laid out stepped terminal block in the connection chamber.

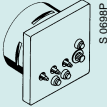
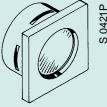
# Zone 1 and Zone 2

**Selection table** – Empty enclosures –

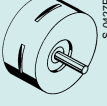
Front plate – available types

	Length of enclosure [mm]	Ordering code		Weight [kg]
		IIC version	IIB version	
 <p>S 0419P</p> <p>Square front plate, plain</p>	160	<b>8218/311-1-004</b>	<b>8218/211-1-004</b>	1,08
	210		<b>8218/212-1-004</b>	1,23
	260		<b>8218/213-1-004</b>	1,38
 <p>S 0489P</p> <p>Square front plate with spindle</p>	160	<b>8218/311-1-014</b>	<b>8218/211-1-014</b>	1,23
	210		<b>8218/212-1-014</b>	1,38
	260		<b>8218/213-1-014</b>	1,53
 <p>S 0441P</p> <p>Square front plate with inspection window Ø 52 mm</p>	160	<b>8218/311-1-104</b>	<b>8218/211-1-104</b>	1,13
	210		<b>8218/212-1-104</b>	1,28
	260		<b>8218/213-1-104</b>	1,43
 <p>S 0487P</p> <p>Round flange, plain</p>	160	<b>8218/311-1-304</b>	<b>8218/211-1-304</b>	1,10
	210		<b>8218/212-1-304</b>	1,25
	260		<b>8218/213-1-304</b>	1,40
 <p>S 0424P</p> <p>Round flange, plain with spindle</p>	160	<b>8218/311-1-314</b>	<b>8218/211-1-314</b>	1,23
	210		<b>8218/212-1-314</b>	1,38
	260		<b>8218/213-1-314</b>	1,53
 <p>S 0425P</p> <p>Round flange with inspection window Ø 52 mm</p>	160	<b>8218/311-1-404</b>	<b>8218/211-1-404</b>	1,13
	210		<b>8218/212-1-404</b>	1,28
	260		<b>8218/213-1-404</b>	1,43
 <p>S 0427P</p> <p>Round metal flange with spindle</p>	160	<b>8218/311-1-724</b>	<b>8218/211-1-724</b>	1,33
	210		<b>8218/212-1-724</b>	1,48
	260		<b>8218/213-1-724</b>	1,63
 <p>S 0428P</p> <p>Round metal flange with bearing-supported shaft</p>	160	<b>8218/311-1-734</b>	<b>8218/211-1-734</b>	1,33
	210		<b>8218/212-1-734</b>	1,48
	260		<b>8218/213-1-734</b>	1,63

**Note**

**Cable gland**

Standard: 1 x M 20 x 1,5 cable glands series 8161

Special: Max. 3 x M 20 x 1,5 cable glands series 8161 or 2 x M 20 x 1,5 metal cable glands available;

Please specify on order.

Enclosures in IIC version are only available in the 160 mm length.

## EEx d Enclosures Flameproof Encapsulation in Moulded Plastic Series 8218

Technical data				
Explosion protection	8218/3: EEx de IIC T6 (only size 1; length 160 mm) 8218/2: EEx de IIB T6 (all sizes)			
Test certificate	8218/3..-1-...: PTB Nr. Ex-92.C.1077 U 8218/2..-1-...: PTB Nr. Ex-92.C.1078 U			
Empty enclosure	8218/3..-5-...: PTB Nr. Ex-92.C.1089 8218/2..-5-...: PTB Nr. Ex-92.C.1090			
Enclosure with internals	Other certificates: FTZU (Czech Republic), BKI (Hungary), SEV (Switzerland)			
Degree of protection	IP 65			
Rated working voltage	max. 660 V			
Rated working current	max. 16 A			
Material	Polyester resin, glass fibre reinforced, dark grey RAL 7024, impact strength $\geq 7$ Nm, surface resistance $\leq 10^9$ Ohm, material self-extinguishing and flame resistant			
Enclosure	Borosilicate glass or quartz glass			
Window	Nitrilbutadiene rubber			
Gasket				
max. power dissipation Volume available for fittings	Type of enclosure	max. power dissipation	Temperature class	Volume available for fittings
	8218/311--...	10 W	T6	310 cm <sup>3</sup>
	8218/211--...	10 W	T6	310 cm <sup>3</sup>
	8218/212--...	16 W	T6	530 cm <sup>3</sup>
	8218/213--...	22 W	T6	750 cm <sup>3</sup>
Mounting	Panel mounting, mounting on mounting plate or flange mounting			
Cable entries	1 x M 20 x 1,5 cable gland series 8161			
Standard	max. 3 x M 20 x 1,5 cable glands series 8161			
Special	or bell-mouthed glands series 8165 or 2 x M 20 metal glands			
Barrier bushings	Conductor bushing 10 x 1,5 mm <sup>2</sup> (others on request)			
Connection	Terminal block with 10 terminals (including 1 terminal for PE-connection) Conductor size: flexible 1,5 mm <sup>2</sup> /solid 2,5 mm <sup>2</sup>			

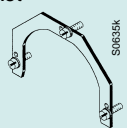
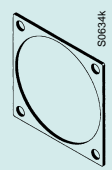
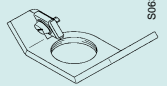

Accessories and spare parts			
Designation	Description	Ordering code	Weight [kg]
Mounting bracket 	for clamping enclosure in the panel cut-out or fixing to mounting plate; complete with screws M 5 x 16	<b>82 188 01 18 0</b>	0,05
Gasket 	for panel mounting	<b>82 189 01 95 0</b>	0,01
Brass plate 	for fitting of metal cable glands M 20 x 1,5	<b>82 189 01 55 0</b>	0,09

Dimensions, all dimensions in mm – subject to alteration

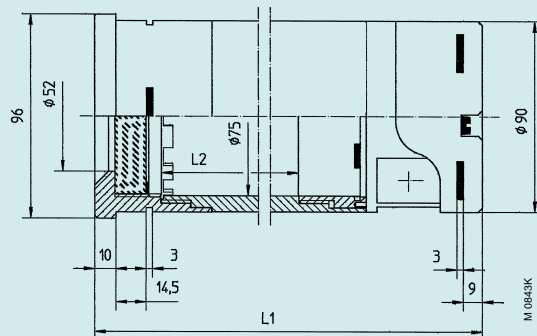
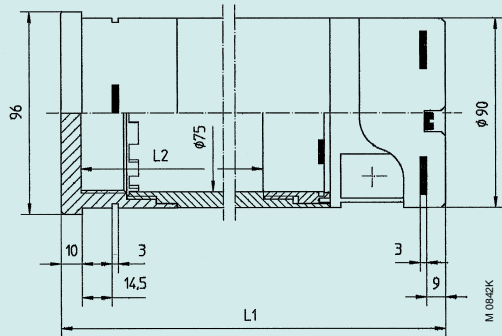

Enclosures	Length of enclosure L1	Clear installation length L2
8218/311	160 mm	ca. 60 mm
8218/211	160 mm	ca. 60 mm
8218/212	210 mm	ca. 110 mm
8218/213	260 mm	ca. 160 mm

Enclosures	Length of enclosure L1	Clear installation length L2
8218/311	160 mm	ca. 40 mm
8218/211	160 mm	ca. 40 mm
8218/212	210 mm	ca. 90 mm
8218/213	260 mm	ca. 140 mm

**Enclosures 8218**  
front plate plain

**Enclosures 8218**  
with inspection window

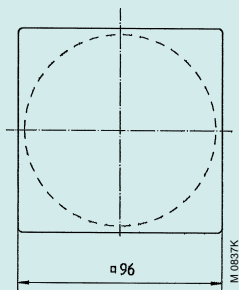

Square front plate, plain

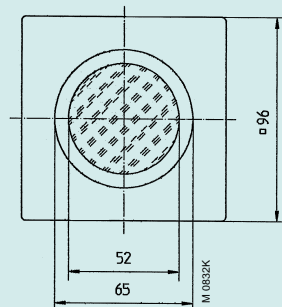

Square front plate  
with inspection window

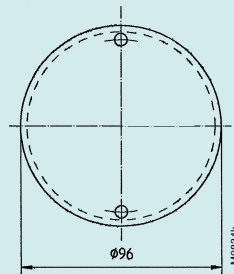

Round front plate, plain

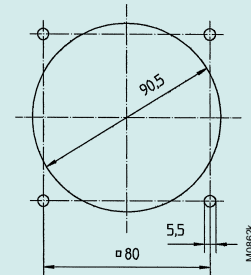

Panel cut-out

**Enclosures series 8218**

