



Control Switch Series 8008

- Explosion protection to
 - CENELEC
 - IEC
- Can be used in Zone 1 and Zone 2
- Up to 4 poles
- No contacts spring-loaded, suitable for EMERGENCY STOP functions
- In latching or spring-return form



STAHL

The switch contact action is freely selectable and can be latching or spring-return.

These control switches can be used for EMERGENCY STOP functions to IEC 204 DIN VDE 0113.

Zone 1 and Zone 2

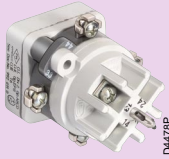
Selection table

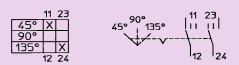
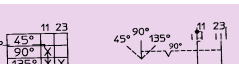
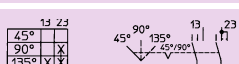
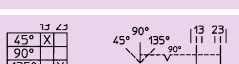
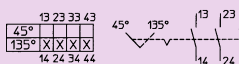
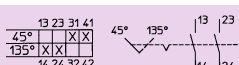
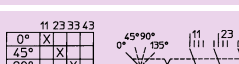
Version	Control switches 8008	Switching arrangements (Examples)	Ordering code		Weight [kg]
			Type no. (for individual order)	Assembly (code for installation)	
 <p>D4478P 8008/2 Control switch</p>	Control switch, 2-pole		8008/2 – 002	160 + 002	0,12
			8008/2 – 016	160 + 016	0,12
			8008/2 – 027	160 + 027	0,12
			8008/2 – 034	160 + 034	0,12
			8008/2 – 038	160 + 038	0,12
			8008/2 – 040	160 + 040	0,12
	Control switch, 4-pole		8008/2 – 102	161 + 102	0,17
			8008/2 – 106	161 + 106	0,17
			8008/2 – 110	161 + 110	0,17



Notes:

The standard contact arrangements are examples, other 3- to 4-pole versions are available, see arrangement diagram part 11

Assembly code for fitting to control equipment 8040 and control stations

Control switches with electronic switching element (contact-free) on request. Other control switches in versions up to 12-poles, Type 8006, catalogue part 11



Selection table					
Actuators	Description	Ordering code		Weight [kg]	
		Type no. (for individual order)	Assembly (code for installation)		
Small rotary actuator	 Ø 40 mm, not lockable Ø 40 mm, lockable in one position for padlocking position	88 000 07 32 7	732	0,022	
		88 000 07 34 7	734	0,025	
Additional labels see 9/92					
Large rotary actuator	 Ø 64 mm, black, not lockable Ø 64 mm, three fold lockable, for padlocking position	88 000 07 31 7	731 – 1 – 0	0,054	
		88 000 07 31 7	731 – 1 – 3	0,054	
Specify labels; see below					
Large rotary actuator with long knob	 Ø 64 mm, black, not lockable Ø 64 mm, three fold lockable for padlocking position	88 000 07 28 7	728 – 1 – 0	0,055	
		88 000 07 28 7	728 – 1 – 3	0,055	
Specify labels; see below					
Symbol discs for large actuators	Text:	0 – I	86 029 11 85 0	86 029 11 85 0	
		0 – • – I	86 029 21 85 0	86 029 21 85 0	
		0 – Operation – I	86 029 12 85 0	86 029 12 85 0	
		0 – I – II	86 029 13 85 0	86 029 13 85 0	
		I – 0 – II	86 029 14 85 0	86 029 14 85 0	
plain, specify symbol		86 029 23 85 0	86 029 23 85 0		

Technical data

Explosion protection	EEx de IIC T6				
Test certificate	PTB Nr. Ex-86.B.1109 U Other certificates: BKI (Hungary), CSA (Canada), FTZU (Czech Republic), PTB (Germany), VNIIEF (Russia), SEV (Switzerland), FM (USA), TÜV Vienna (Austria), SIMTARS (Australia), UL (USA)				
Enclosure material	Polyester				
Rated voltage	690 V + 5 %, AC1, 220 V DC 1				
Rated current	16 A				
Switching capacity to IEC 337-1		220/230/240 V~	380/400/415 V~	500 V~	660/690 V~
	AC 11 cos φ = 0,7	6 A	6/5 A	4 A	2,5 A
	AC 3 cos φ = 0,65	16 A	16 A	8 A	4 A
	DC DC 11, L/R = 100 ms		60 V~ 1 A	110 V~ 0,6 A	220 V~ 0,4 A
Contacts	max. 4-pole; NC contact for EM-STOP function				
Switching angle	n x 30°/n x 45°/n x 90°				
Life mechanical/electrical	≥ 10 ⁶ operations				
Ambient temperature	–20° C ... +40° C				
Terminals	2,5 mm ² flexible				

Continuation →

Technical data (Continuation)

Actuators

Material	Polyamide
Impact strength	≥ 7 Nm
Degree of protection	IP 65 (IP 66/IP 67 on request)
Sealing material	Neoprene
Symbol discs	PVC
Actuator small Ø 40 mm	a) not lockable b) lockable in one position with bracket in black or red/yellow
large Ø 64 mm	a) with protective collar, not lockable b) with protective collar, can be locked up to 3 padlocks

Dimensions, all dimensions in mm – subject to alteration

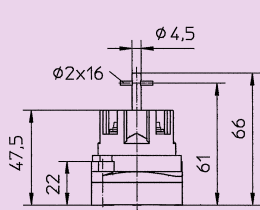

2-poles

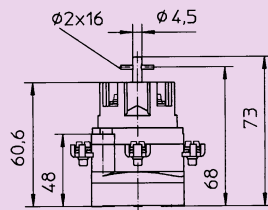
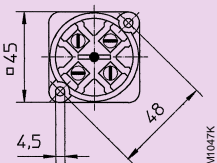

4-poles

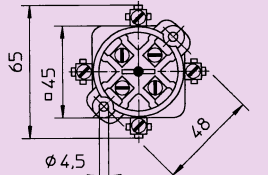

8008/2
Control switches

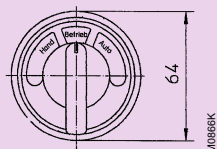
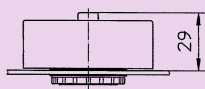

Rotary actuator, large,
for 8008, assembly 731

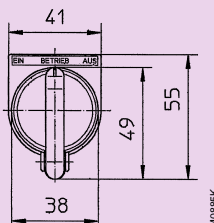
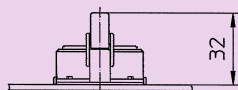

Rotary actuator, small, lockable,
for 8008, assembly 734

