





Illuminated Pushbutton Series 8082, 8010

- Explosion protection to
 - CENELEC
 - IEC
- Can be used in Zone 1 and Zone 2
- Contact element and indicating lamp combined below one actuator
- Control and indicator function in one location
- Switching and indicator functions independent of each other
- Various switching / indicator functions
 - Request: pushbuttons lights up indicating that the button is to be pushed
 - Confirmation: after pushing button to provide required action, light goes off, confirming that action was successful
- Available in white, red, green, yellow and blue
- Rated voltage
20 V – 15 % ... 254 V + 6 %

STAHL

Zone 1 and Zone 2

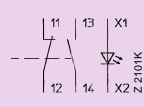
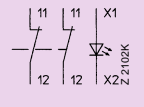
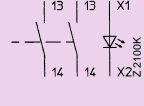
Selection table

Designation	Description	Ordering code		Weight [kg]																								
		Type no. (for individual order)	Assembly (Code for in- stallation)																									
 <p>8082/8010 Illuminated contact block</p> <p>D4427P</p>	<p>Contacts</p> <p>Indicating lamp</p> <p>Voltage Colour</p>	<p>20 ... 254 V AC/DC</p>	<p>white</p> <p>red</p> <p>green</p> <p>yellow</p> <p>blue</p>	<p>8800/737 - 7 - ws</p> <p>8800/737 - 7 - rt</p> <p>8800/737 - 7 - gn</p> <p>8800/737 - 7 - ge</p> <p>8800/737 - 7 - bl</p>	<p>737 - ws</p> <p>737 - rt</p> <p>737 - gn</p> <p>737 - ge</p> <p>737 - bl</p>	<p>0,085</p> <p>0,085</p> <p>0,085</p> <p>0,085</p> <p>0,085</p>																						
							<p>1 NC + 1 NO</p> 	<p>20 ... 254 V AC/DC</p>	<p>white</p> <p>red</p> <p>green</p> <p>yellow</p> <p>blue</p>	<p>8800/738 - 7 - ws</p> <p>8800/738 - 7 - rt</p> <p>8800/738 - 7 - gn</p> <p>8800/738 - 7 - ge</p> <p>8800/738 - 7 - bl</p>	<p>738 - ws</p> <p>738 - rt</p> <p>738 - gn</p> <p>738 - ge</p> <p>738 - bl</p>	<p>0,085</p> <p>0,085</p> <p>0,085</p> <p>0,085</p> <p>0,085</p>																
							<p>2 NC</p> 						<p>20 ... 254 V AC/DC</p>	<p>white</p> <p>red</p> <p>green</p> <p>yellow</p> <p>blue</p>	<p>8800/739 - 7 - ws</p> <p>8800/739 - 7 - rt</p> <p>8800/739 - 7 - gn</p> <p>8800/739 - 7 - ge</p> <p>8800/739 - 7 - bl</p>	<p>739 - ws</p> <p>739 - rt</p> <p>739 - gn</p> <p>739 - ge</p> <p>739 - bl</p>	<p>0,085</p> <p>0,085</p> <p>0,085</p> <p>0,085</p> <p>0,085</p>											
							<p>2 NO</p> 											<p>20 ... 254 V AC/DC</p>	<p>white</p> <p>red</p> <p>green</p> <p>yellow</p> <p>blue</p>	<p>8800/735 - 7 - ws</p> <p>8800/735 - 7 - rt</p> <p>8800/735 - 7 - gn</p> <p>8800/735 - 7 - ge</p> <p>8800/735 - 7 - bl</p>	<p>735 - ws</p> <p>735 - rt</p> <p>735 - gn</p> <p>735 - ge</p> <p>735 - bl</p>	<p>0,021</p> <p>0,021</p> <p>0,021</p> <p>0,021</p> <p>0,021</p>						
							 <p>Actuator for illuminated pushbutton</p> <p>D4428P</p>																<p>Actuator: spring-return</p>	<p>Colour of lens</p>	white	8800/735 - 7 - ws	735 - ws	0,021
																									red	8800/735 - 7 - rt	735 - rt	0,021
																									green	8800/735 - 7 - gn	735 - gn	0,021
																									yellow	8800/735 - 7 - ge	735 - ge	0,021
																									blue	8800/735 - 7 - bl	735 - bl	0,021

Attention: Illuminated pushbutton should not be used for EMERGENCY-STOP functions.



Technical data

Explosion protection	EEx de IIC T6
Test certificate Contact block Indicating lamp Actuator	PTB Nr. Ex-92.C.1092U PTB Nr. Ex-94.C.2080U PTB Nr. Ex-94.C.3114U
Version	Available in spring-return version; bezel black, indicating lamp in white, red, yellow, blue or green
Ambient temperature	- 20° C ... + 40° C
Terminals	2,5 mm ² flexible

Contact block 8082/1

Enclosure material	Polyamide
Rated voltage	max. 500 V
Rated current	max. 6 A
Contact material	Silver-nickel

Indicating lamp 8010

Enclosure material	Polyester
Rated voltage	20 V - 15 % ... 254 V + 6 %
Frequency	0 ... 60 Hz
Electrical life	10 ⁵ output hours
Colour	Red, yellow, green, white, blue

Actuators

Material	Polyamide
Impact strength	≥ 7 Nm
Gaskets	NBR
Degree of protection	IP 66



Accessories and spare parts

Symbol disc		For actuators to fit in standard Ø 30,5 mm holes:	
		Label mount, size 1, without symbol disc Symbol disc, specify text	86 029 04 80 0
		Label mount, size 2, without symbol disc Symbol disc, specify text	86 028 07 80 0
		Additional labels: plain	
		Text options: HAND-0-AUTO OFF-□-ON 0-1 I-II I-0-II 0-I-II 0-Operation-I 0-□-I 0-I	

Dimensions, all dimensions in mm – subject to alteration

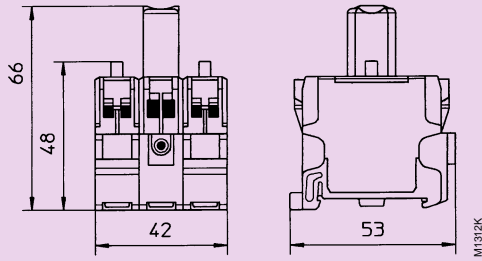

Illuminated pushbutton
Assemblies 737, 738, 739

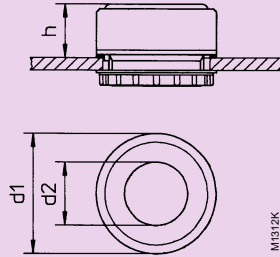

Indicating lamp bezel

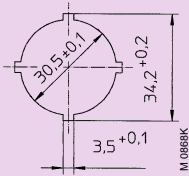

Cut-out details

Type	Dimensions [mm]		
	h	d1	d2
8010	18	38	20
8017	18	38	26