

# ADAPTA

## SURFACE-MOUNTED FLUORESCENT

## INTERIOR

The Adapta is a versatile marine luminaire constructed from white painted aluminium with an opal polycarbonate diffuser. It is available as a basic luminaire or with an on/off 2 pole switch and/or a Euro Schuko 2-pin 16A socket outlet(no fuse).

The Adapta is easy to install with a range of mounting accessories to choose from i.e. wire suspension, chain suspension and edge connectors for 45° and 90° mounting. In addition to these there is the option of in-line connectors which allow a number of Adaptas to be built into an integrated luminaire system. Perforated shields, which eliminate glare, are available for basic models only.

The Adapta range is suitable for a wide range of T8 and compact fluorescent lamps.



**APPLICATIONS:** Suitable for accommodation areas, berths, shower rooms and bathrooms

### STANDARD SPECIFICATION

|                     |   |
|---------------------|---|
| Ingress Protection: | <b>IP44 to EN 60529</b>   |
| Enclosure:          | <b>White painted aluminium construction c/w opal polycarbonate diffuser</b> |
| Entries:            | <b>Ø20mm knock-outs</b>   |
| Internal Wiring:    | <b>Stranded, heat resistant wiring to 105 °C max</b>                        |
| Termination:        | <b>3 core 2.5mm<sup>2</sup> max conductors</b>                              |
| Mounting:           | <b>Mounted directly to wall or ceiling. Installation kit supplied.</b>      |
| Control Gear:       | <b>Switch start copper/iron control gear and PFC capacitor.</b>             |
| Relamping:          | <b>Via diffuser</b>   |
| Electrical Supply:  | <b>230V 50Hz (always state V/Hz when ordering)</b>                          |

### STANDARD PRODUCT RANGE

| Catalogue No.      | Wattage (W) | Lamp Type | Lampholder | Weight  |
|--------------------|-------------|-----------|------------|---------|
| <b>ADAI/111/CF</b> | 11          | PL-S/2P   | G23        | 0.9 Kgs |
| <b>ADAI/115/BI</b> | 15          | T8        | G13        | 1.8 Kgs |
| <b>ADAI/118/BI</b> | 18          | T8        | G13        | 1.8 Kgs |
| <b>ADAI/136/BI</b> | 36          | T8        | G13        | 2.5 Kgs |
| <b>ADAI/158/BI</b> | 58          | T8        | G13        | 3.2 Kgs |

### OPTIONS - Suffix to Catalogue No.

|                |  |
|----------------|--|
| <b>/60</b>     | 60Hz   |
| <b>/120/60</b> | 120V/60Hz Supply for 15W & 18W Models (Basic and switch only models) |
| <b>/SW</b>     | On/off 2-pole switch (all models)                                    |
| <b>/SO</b>     | 16A Socket outlet (11W,15W & 18W models only)                        |

**ACCESSORIES** (Ordered separately)

- Wire suspension kit
- Chain suspension kit
- In-line connector kit
- Edge connector kit 45°
- Edge connector kit 90°
- Perforated shield for basic 11W Model
- Perforated shield for basic 15W Model
- Perforated shield for basic 18W Model
- Perforated shield for basic 36W Model
- Perforated shield for basic 58W Model

**CATALOGUE ORDER CODE**

- SADAI-0001
- SADAI-0002
- SADAI-0003
- SADAI-0004
- SADAI-0005
- SADAI-0006
- SADAI-0007
- SADAI-0008
- SADAI-0009
- SADAI-0010

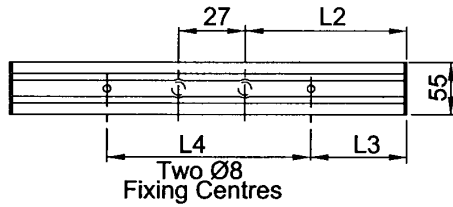

| Model | L1   | L2    | L3    | L4   |
|-------|------|-------|-------|------|
| 1x11W | 335  | 190.5 | 29    | 215  |
| 1x15W | 479  | 260.5 | 71    | 333  |
| 1x18W | 631  | 300   | 93.5  | 440  |
| 1x36W | 1241 | 605   | 148.5 | 940  |
| 1x58W | 1541 | 755   | 148.5 | 1140 |

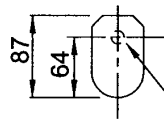
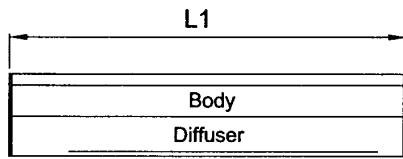

Cable Entry Options  
One Ø20 Knock-out at either end of the luminaire and two at 27mm Centres on the topside of the luminaire

**BASIC ADAPTA**  
(no switch or socket)

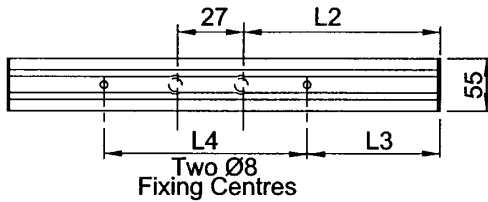

| Model | L1   | L2    | L3    | L4   |
|-------|------|-------|-------|------|
| 1x11W | 369  | 226.5 | 65    | 215  |
| 1x15W | 523  | 307   | 117   | 333  |
| 1x18W | 675  | 346   | 139.5 | 440  |
| 1x36W | 1285 | 651   | 194.5 | 940  |
| 1x58W | 1585 | 801   | 194.5 | 1140 |

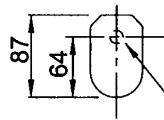
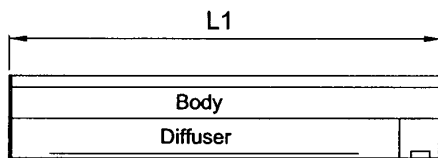

Cable Entry Options  
One Ø20 Knock-out at either end of the luminaire and two at 27mm Centres on the topside of the luminaire

**ADAPTA**  
(c/w switch)

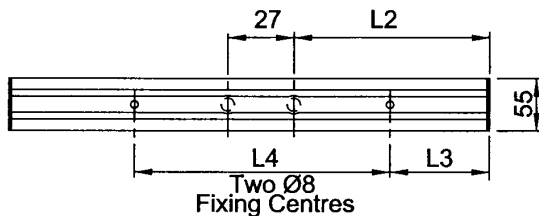

| Model | L1  | L2    | L3    | L4  |
|-------|-----|-------|-------|-----|
| 1x11W | 436 | 226.5 | 65    | 215 |
| 1x15W | 599 | 307   | 117   | 333 |
| 1x18W | 751 | 346   | 139.5 | 440 |

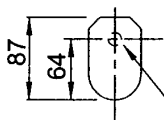
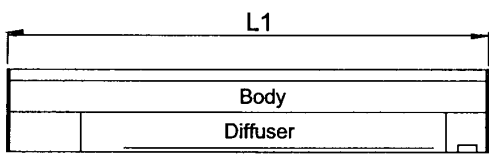

Cable Entry Options  
One Ø20 Knock-out at either end of the luminaire and two at 27mm Centres on the topside of the luminaire

**ADAPTA**  
(c/w switch & socket)