

ABSO[®]

ABSOLUTELY COMPLETE CIRCUIT
ELECTRICAL CONDUIT & FITTINGS

ONE BRAND ONE SOLUTION



EMT

Specifications
ELECTRICAL
METALLIC
TUBING

IMC

Specifications
INTERMEDIATE
METAL
CONDUIT

RSC

Specifications
GALVANIZED
RIGID STEEL
CONDUIT

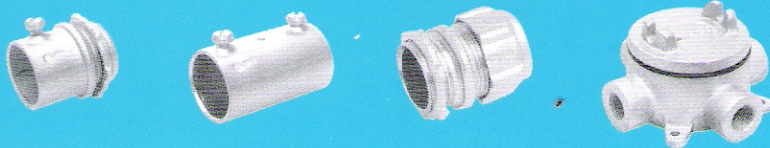

Electrical Metallic Tubing
Intermediate Metal Conduit and Rigid Steel Conduit

EMT

Specifications
ELECTRICAL
METALLIC
TUBING

IMC

Specifications
INTERMEDIATE
METAL
CONDUIT

RSC

Specifications
GALVANIZED
RIGID STEEL
CONDUIT

ANSI C80.3-1986 ● HOT DIP GALVANIZED coating physically bonded to steel seals out rust.

● UNIFORM WALL THICKNESS

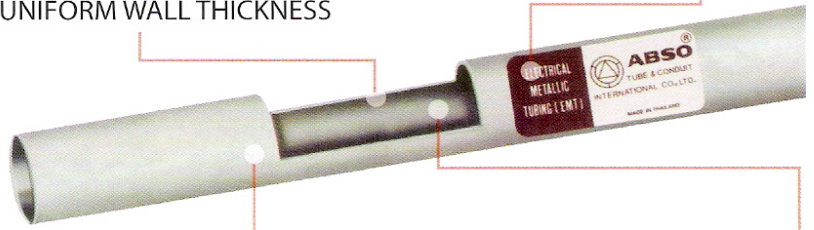

● DUCTILE STEEL for easy cuts and bends. Reduces waste and installation time.

● EASY-PULLING INTERIOR coated with a protective lubricant that helps wires glide through

ANSI C80.6-1986/UL1242 ● UNIFORM WALL THICKNESS

● USES SAME THREADED FITTINGS as approved for Rigid conduit.



● THREADED ONE THREAD SHORT to prevent butting within the coupling, ensuring a good ground return path.

● HOT DIP GALVANIZED coating physically bonded to steel seals out rust.

ANSI C80.1-1986 ● UNIFORM WALL THICKNESS



● THREADED ONE THREAD SHORT to prevent butting within the coupling, insuring a good ground return path.

● HOT DIP GALVANIZED coating physically bonded to steel seals out rust.

ABSO EMT CONDUIT STANDARD SPECIFICATION

ANSI C80.3-1986

Nominal size	Outside Diameter		Wall Thickness		Length		Calculated Weight		Number of Pieces in Std. Packing	
	inch	mm	inch	mm	ft	mm	kg/m	kg/p	Per Bundle	Per Lift
½	0.706	17.93	0.042	1.07	10	3048	0.445	1.365	10	100
¾	0.922	23.42	0.049	1.24	10	3048	0.678	2.067	10	100
1	1.163	29.54	0.057	1.45	10	3048	1.004	3.061	7	70
1 ¼	1.510	38.35	0.065	1.65	10	3048	1.493	4.552	5	50
1 ½	1.740	44.20	0.065	1.65	10	3048	1.731	5.277	5	50
2	2.197	55.80	0.065	1.65	10	3048	2.203	6.716	2	30

Tolerance : Outside Diameter : ±0.13mm Wall Thickness : ±10% Length : ±6.4 mm

ABSO IMC CONDUIT STANDARD SPECIFICATION

ANSI C80.6-1986/UL1242

Nominal size	Outside Diameter		Wall Thickness		Length without coupling		Calculated Weight			Number of Pieces in Std. Packing	
	inch	mm	inch	mm	ft	mm	kg/m	kg/p*	kg/p**	Per Bundle	Per Lift
½	0.815	20.7	0.073	1.85	9-11¼	3029	0.860	2.605	2.655	10	100
¾	1.029	26.1	0.079	2.0	9-11¼	3029	1.189	3.601	3.701	10	100
1	1.290	32.8	0.091	2.3	9-11½	3023	1.730	5.230	5.380	5	50
1 ¼	1.638	41.6	0.091	2.3	9-11½	3023	2.229	6.738	6.918	3	30
1 ½	1.882	47.8	0.093	2.35	9-11	3023	2.634	7.963	8.163	3	30
2	2.360	59.9	0.096	2.45	9-11	3023	3.471	10.493	10.943	2	20
2 ½	2.857	72.6	0.134	3.4	9-10	3010	5.802	17.464	18.364	2	20
3	3.476	88.3	0.134	3.4	9-10	3010	7.118	21.425	22.425	1	10
3 ½	3.971	100.9	0.134	3.4	9-10¼	3004	8.175	24.558	25.858	1	10
4	4.466	113.4	0.134	3.4	9-10¼	3004	9.223	27.706	29.606	1	10

Tolerance : Outside Diameter : ±0.2 mm F(For ½"-1") ±0.3 mm (For 1¼"-2") ±0.4 mm (For 2½"- 4")

Wall Thickness : ±0.2mm(For ½"-2") ±0.3mm(For 2½"-4")

Length : ± 6.4 mm

Remarks : *weight without coupling **weight with coupling

ABSO RSC CONDUIT STANDARD SPECIFICATION

ANSI C80.1-1986

Trade Size, Inches	Approx. Wt. per 100 Ft. (30.5m) (with couplings attached)		Nominal Outside Dia. ¹		Nominal Wall Thickness ²		Length of Finished Conduit (without coupling) ³		Quantity in Primary Bundle		Quantity in Master Bundle		Approx. Wt. of Master Bundle		Volume of Master Bundle	
	lb	kg	in	mm	in	mm	ft and in	m	ft	m	ft	m	lb	kg	cu ft	cu m
½	80	36.29	0.840	21.3	0.104	2.6	9' 11¼"	3.03	100	30.48	2,500	762	2,000	907	13.9	.3934
¾	109	49.44	1.050	26.7	0.107	2.7	9' 11¼"	3.03	50	15.24	2,000	610	2,180	989	19.9	.5632
1	165	74.84	1.315	33.4	0.125	3.2	9' 11 "	3.02	50	15.24	1,300	396	2,145	973	18.3	.5179
1 ¼	215	87.52	1.660	42.2	0.133	3.4	9' 11 "	3.02	30	9.14	900	274	1,935	878	19.2	.5434
1 ½	258	117.03	1.900	48.3	0.138	3.5	9' 11 "	3.02	-	-	800	244	2,064	936	22.6	.6395
2	352	159.67	2.375	60.3	0.146	3.7	9' 11 "	3.02	-	-	600	183	2,112	958	24.3	.6877
2 ½	567	257.19	2.875	73.0	0.193	4.9	9' 10½"	3.01	-	-	400	122	2,268	1,029	17.2	.4868
3	714	323.87	3.500	88.9	0.205	5.2	9' 10½"	3.01	-	-	300	91	2,142	972	27.8	.7867
3 ½	860	390.10	4.000	101.6	0.215	5.5	9' 10¼"	3.00	-	-	250	76	2,150	975	32.5	.9198
4	1,000	453.60	4.500	114.3	0.225	5.7	9' 10¼"	3.00	-	-	200	61	2,000	907	29.5	.8349
5	1,320	598.75	5.563	141.3	0.245	6.2	9' 10 "	3.00	-	-	100	31	1,320	599	25.6	.7245
6	1,785	809.68	6.625	168.3	0.266	6.8	9' 10 "	3.00	-	-	100	31	1,785	810	35.6	1.0075

1 Outside diameter tolerances : ± 0.015 in (.38 mm) for thread sizes ½" through 2". ± 0.25 in (6.35 mm) for thread sizes 2½" through 4". ± 1% for thread sizes 5" and 6"

2 For information only ; not a spec requirement.

3 Length tolerance : ± 0.25" (6.35 mm).

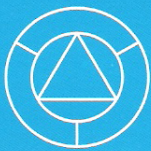

ABS O[®]

ABSOLUTELY COMPLETE CIRCUIT
ELECTRICAL CONDUIT & FITTINGS

FITTINGS

Electrical Metallic Tubing

EMT

Conduit Connector



∅ 1/2" - 2"

Conduit Coupling

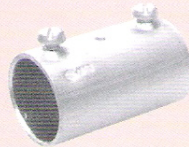

∅ 1/2" - 2"

Connector Rain Tight



∅ 1/2" - 2"

Coupling Rain Tight



∅ 1/2" - 2"

Intermediate Metal Conduit and Rigid Steel Conduit

IMC & RSC

ANSI/NEMA FB 1-O.C.
CONDULET CAST IRON
LIQUID-TIGHT IP54

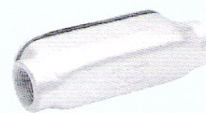

∅ 1/2" - 2"

ANSI/NEMA FB 1-O.T.
CONDULET CAST IRON
LIQUID-TIGHT IP54

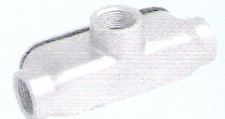

∅ 1/2" - 4"

ANSI/NEMA FB 1-CONDUIT OUTLET BODIES AND BOXES IP54



∅ 1/2" - 2"

ANSI/NEMA FB 1-FS/FD
BOXES 2" X 4"
ONE GANG. IP41

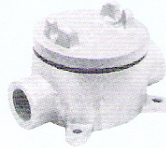

∅ 1/2" - 2"

ANSI/NEMA FB 1-FS/FD
BOXES 4" X 4"
TWO GANG. IP41



∅ 1/2" - 2"

ANSI/NEMA FB 1-FS/FD
BOXES 2" X 4"
ONE GANG. IP41



∅ 1/2" - 2"

ANSI/NEMA
FB 1-LOCKNUTS



∅ 1/2" - 2"

ANSI/NEMA
FB 1-BUSHING



∅ 1/2" - 1"

ERICSSON COUPLING

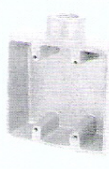

∅ 1/2" - 1"

COUPLING R.G.

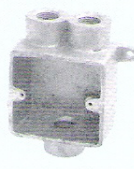

3/4"

ANSI/NEMA FB 1 HUB RAIN TIGHT
FOR RIGID, IMC CONDUIT [NPT]
CAST IRON HOT-DIP GALVANIZED
IP 54

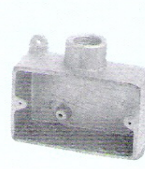

3/4"

ANSI/NEMA FB 1-CHASE
NIPPLE



∅ 1/2" - 6"



∅ 1/2" - 4"

ANSI/NEMA
FB 1-LOCKNUT

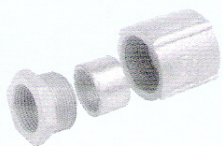

∅ 1/2" - 6"

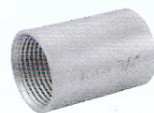

∅ 1/2" - 6"



∅ 1/2" - 4"



∅ 1/2" - 6"



∅ 1/2" - 4"

Strap

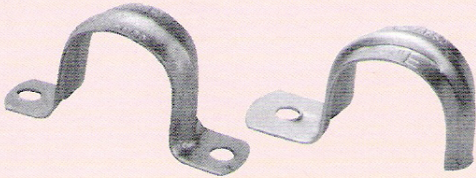

Ø ½" - 2"

Electrical Metallic Tubing Elbows90°



Ø ½" - 2"

Flexible Conduit

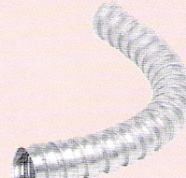

Ø ½" - 2"

Flexible Connector

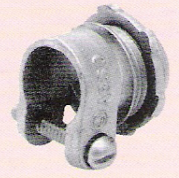

Ø ½" - 2"

ANSI/NEMA FB 1-L.B. CONDULET CAST IRON LIQUID-TIGHT IP54

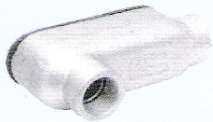

Ø ½" - 4"

ANSI/NEMA FB 1-L.L. CONDULET CAST IRON LIQUID-TIGHT IP54



Ø ½" - 4"

ANSI/NEMA FB 1-L.R. CONDULET CAST IRON LIQUID-TIGHT IP54



Ø ½" - 4"

ANSI/NEMA FB 1 HOT-DIP BLANK FOR L.B., L.L., L.R., O.C., O.T., T.B.



Ø ½" - 4"

ANSI/NEMA FB 1 NEOPREN GASKET FOR L.B., L.L., L.R., O.C., O.T., T.B.



Ø ½" - 4"

ANSI/NEMA FB 1-CIRCULAR JUNCTION BOXES IP41



Ø ½" - 1"



Ø ½" - 1"

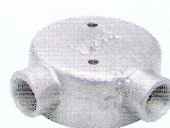

Ø ½" - 1"

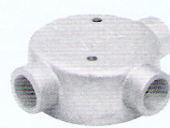

Ø ½" - 1"



Ø ½" - 1"

INTERMEDIATE METAL CONDUIT[IMC] ELBOWS 90° RIGID STEEL CONDUIT[IMC] ELBOWS 90°



Ø ½" - 4"



Ø ½" - 6"



Ø ½" - 4"

STRAPS R.G.



ANSI/NEMA FB 1-CIRCULAR JUNCTION BOXES FOR SUPPORT LIGHTING [PENDANT]



ANSI/NEMA FB 1-CIRCULAR JUNCTION BOXES IP41

CLOSE NIPPLE



Ø ½" - 4"

THREADED CLOSE-UP PLUG



Ø ½" - 1"

REDUCING BUSHINGS [MALE/FEMALE]



Ø ¾" * ½" - 4" * 3 ½"

RAIN TIGHT FLEXBLE CONDUIT "ARROWTITE"

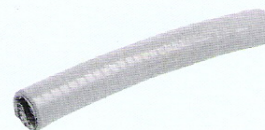

Ø ½" - 4"

FLEXIBLE CONNECTOR RAIN TIGHT



Ø ½" - 4"